

Petroleum Manifold for Tank Trucks

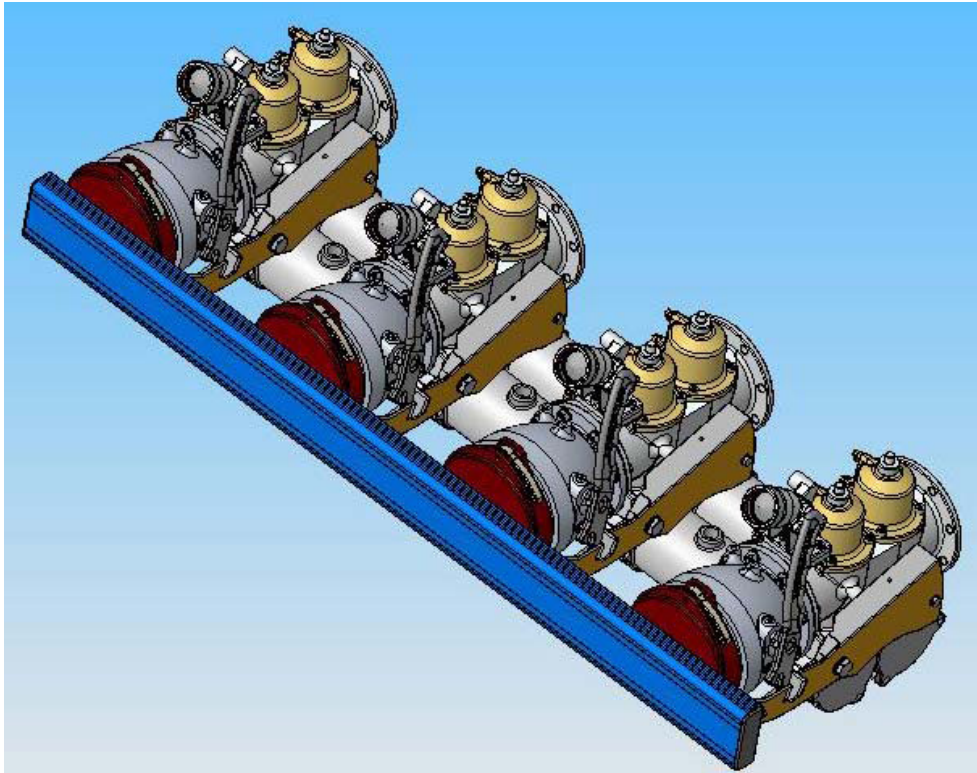

Installation Instruction

Suggested Mounting Arrangements

The Civacon manifold must be supported by dedicated structural supports. The supporting brackets may be bolted to the frame or welded to the tank, as shown below.

CAUTION: The manifold cannot be supported by product piping alone.

CAUTION: Mounting configurations are provided as suggestions only. Securing the manifold to the truck is the sole responsibility of the installer. Civacon assumes no responsibility for the attachment of the manifold.

Suggested Installation Configurations

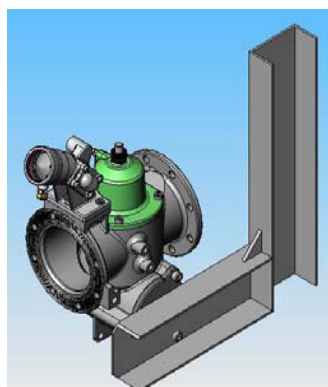

Mounting to Tank

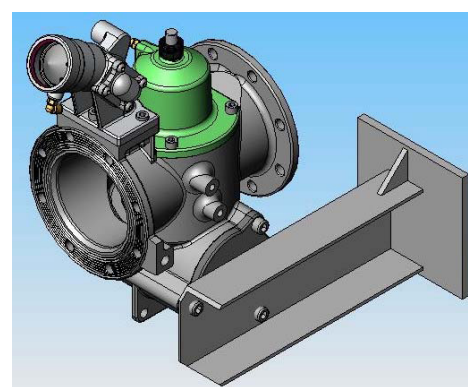
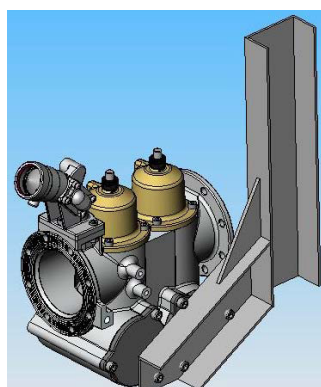

Mounting to Truck Frame

- Mounting illustration uses 4 x .150 aluminum channel
- At Least 3/4" (19mm) of thread engagement is required in the manifold body. Six M10-1.5 x 35 long, Class 8.8 zinc plated socket head cap screws (P/N 10576M) are supplied for this purpose. These longer screws will replace the standard M10-1.5 x 30 long screws that are used to fasten the end caps at the factory.
- If the supporting material is thicker than 3/16", then longer M10-1.5 Class 8.8 screws must be used.